



### Price Index



7 Widths  
8 Bending Radii



3 options for interior separation



5 options for mounting brackets



Various strain relief options

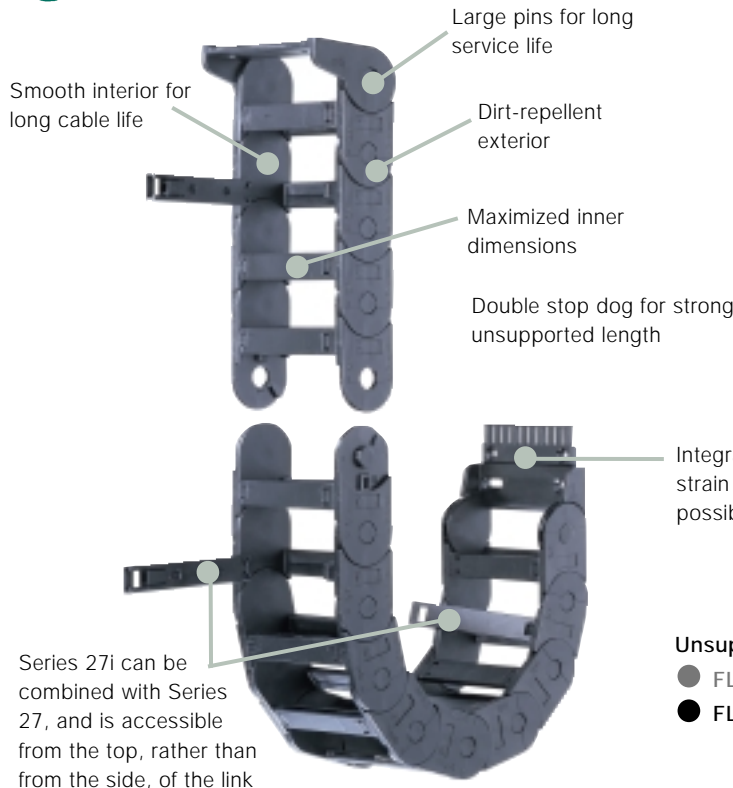

Series 27i can be combined with Series 27, and is accessible from the top, rather than from the side, of the link

### Product Range:

|                                |  |
|--------------------------------|--|
| Inner Widths (Bi) inches (mm): | 1.97 (50), 2.95 (75), 3.94 (100),<br>4.92 (125), 5.91 (150), 6.89 (175),<br>7.87 (200)             |
| Bending Radii (R) inches (mm): | 2.48 (63), 2.95 (75), 3.94 (100),<br>4.92 (125), 5.91 (150), 6.89 (175),<br>7.87 (200), 9.84 (250) |
| Pitch:                         | 2.20 (56 mm/link) =<br>5.49 links/ft (18 links/m)<br>39.4 (1008 mm)                                |



**When to use the Series 26/27/27i:**

- If snap-open accessibility along inner or outer radius is required
- If stable chain of moderate size is required
- If cables up to Ø1.26" (32 mm) diameter are involved
- If loads are moderate
- If integrated strain relief is required at the connection point
- If easy installation is required

- Accessories for  
▶ Guide Troughs,  
Chapter 9
- Further information  
▶ Design, Chapter 1



**When not to use the Series 26/27/27i:**

- If cables over Ø 1.26" (32 mm) diameter are involved  
▶ System E2, Series 340, 350,  
Chapter 4
- If maximum stability is required  
▶ System E4, Series 280,  
Chapter 6
- If chip protection is required  
▶ Energy Tube E2, Series R58,  
Chapter 5  
Series R157/R158, Page 6.10
- If the application is very simple  
▶ "E-Z Chain", Series E26,  
Chapter 2

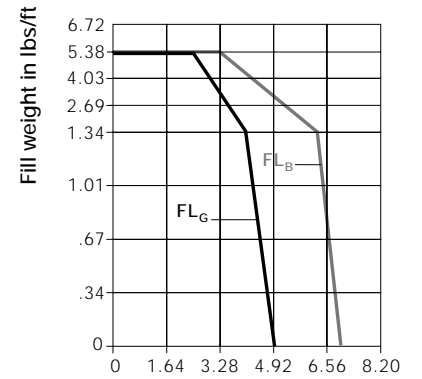

Unsupported length in ft  $FL_B / FL_G$

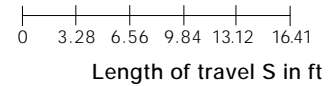

### Unsupported length

- $FL_B$  = unsupported with permitted sag
- $FL_G$  = unsupported with straight upper run

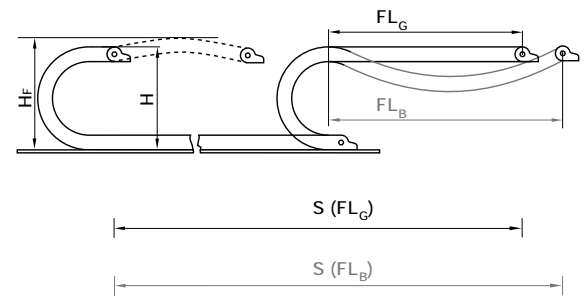

Unsupported Energy Chains® ▶ **Design, Chapter 1**, feature positive camber over short travels. This must be accounted for when specifying the clearance height. Please refer to **Installation dimensions** for further details.

If the unsupported length is exceeded, the Energy Chain®/Tube must glide on itself. This requires a guide trough ▶ **Design, Chapter 1** or incorporation of igus® exclusive AUTO-GLIDE System guide elements, which are available for this chain series ▶ **AUTO-GLIDE System, Chapter 9**.

### Other Installation Methods:

|                           |                                |
|---------------------------|--------------------------------|
| Vertical, hanging         | = max 164 (50 m)               |
| Vertical, standing        | = max 9.84 (3 m)               |
| Side-mounted, unsupported | = max 3.28 (1 m)               |
| Rotary                    | = requires further calculation |

- Long travel Max: 393 ft (120 m)

# Series 26/27/27i E2 "medium"



26  
27  
27i

## Series 26 Energy Chain® (non-snap-open)

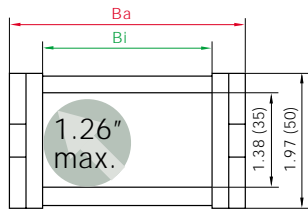

| Part No. | Bi         | Ba         |
|----------|------------|------------|
| 26-05    | 1.97 (50)  | 2.60 (66)  |
| 26-07    | 2.95 (75)  | 3.58 (91)  |
| 26-10    | 3.94 (100) | 4.57 (116) |
| 26-12    | 4.92 (125) | 5.55 (141) |
| 26-15    | 5.91 (150) | 6.54 (166) |
| 26-17    | 6.89 (175) | 7.64 (194) |
| 26-20    | 7.87 (200) | 8.62 (219) |

Bending Radii  
for ALL Widths  
2.48 (063)  
2.95 (075)  
3.94 (100)  
4.92 (125)  
5.91 (150)  
6.89 (175)  
7.87 (200)  
9.84 (250)

Supplement part no. with required radius  
for example, 26-10-100-0

## Series 27i Energy Chain® (snap-open along inner radius)

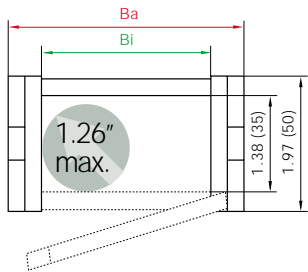

| Part No. | Bi         | Ba         |
|----------|------------|------------|
| 27i-05   | 1.97 (50)  | 2.60 (66)  |
| 27i-07   | 2.95 (75)  | 3.58 (91)  |
| 27i-10   | 3.94 (100) | 4.57 (116) |
| 27i-12   | 4.92 (125) | 5.55 (141) |
| 27i-15   | 5.91 (150) | 6.54 (166) |
| 27i-17   | 6.89 (175) | 7.64 (194) |
| 27i-20   | 7.87 (200) | 8.62 (219) |

Bending Radii  
for ALL Widths  
2.48 (063)  
2.95 (075)  
3.94 (100)  
4.92 (125)  
5.91 (150)  
6.89 (175)  
7.87 (200)  
9.84 (250)

Supplement part no. with required radius  
for example, 27i-10-100-0

## Series 27 Energy Chain® (snap-open along outer radius)

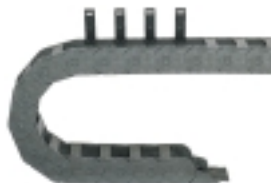
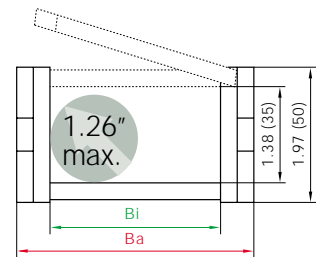

| Part No. | Bi         | Ba         |
|----------|------------|------------|
| 27-05    | 1.97 (50)  | 2.60 (66)  |
| 27-07    | 2.95 (75)  | 3.58 (91)  |
| 27-10    | 3.94 (100) | 4.57 (116) |
| 27-12    | 4.92 (125) | 5.55 (141) |
| 27-15    | 5.91 (150) | 6.54 (166) |
| 27-17    | 6.89 (175) | 7.64 (194) |
| 27-20    | 7.87 (200) | 8.62 (219) |

Bending Radii  
for ALL Widths  
2.48 (063)  
2.95 (075)  
3.94 (100)  
4.92 (125)  
5.91 (150)  
6.89 (175)  
7.87 (200)  
9.84 (250)

Supplement part no. with required radius  
for example, 27-10-100-0

**!** Series 27 is the standard chain for long travels (gliding applications)

## Installation Dimensions

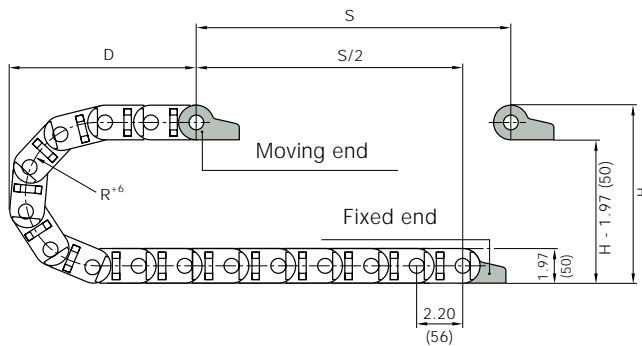

| R                              | 2.48 (063)  | 2.95 (075)  | 3.94 (100)  | 4.92 (125)  |
|--------------------------------|-------------|-------------|-------------|-------------|
| H*) <sup>+5</sup> <sub>0</sub> | 7.09 (180)  | 7.87 (200)  | 9.84 (250)  | 11.81 (300) |
| D                              | 5.51 (140)  | 5.91 (150)  | 6.89 (175)  | 7.87 (200)  |
| K                              | 13.19 (335) | 14.76 (375) | 18.70 (475) | 21.65 (550) |

| R                              | 5.91 (150)  | 6.89 (175)  | 7.87 (200)  | 9.84 (250)  |
|--------------------------------|-------------|-------------|-------------|-------------|
| H*) <sup>+5</sup> <sub>0</sub> | 13.78 (350) | 15.75 (400) | 17.72 (450) | 21.65 (550) |
| D                              | 8.86 (225)  | 9.84 (250)  | 10.83 (275) | 12.80 (325) |
| K                              | 25.59 (650) | 29.53 (750) | 32.48 (825) | 36.42 (925) |

\*The required clearance height is HF = H + 1.38 (35 mm) with 1.34 lbs/ft (2 kg/m) fill weight. Please consult igus® if space is particularly restricted.

Pitch: = 2.20 (56 mm) per link  
Links per ft (m): = 5.49 (18)  
Chain length: =  $\frac{S}{2} + K$

Series  
26/27/27i

Telephone 1-800-521-2747  
Fax 1-401-438-7270

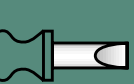

SnapChain - Easily Bundle Cables Together

New!

igus<sup>®</sup> Energy Chain Systems<sup>®</sup>Telephone 1-800-521-2747  
Fax 1-401-438-7270igus<sup>®</sup>, inc.  
USA/Canada  
MexicoInternet: <http://www.igus.com>  
email: [webmaster@igus.com](mailto:webmaster@igus.com)

4.56

Adjustable loops

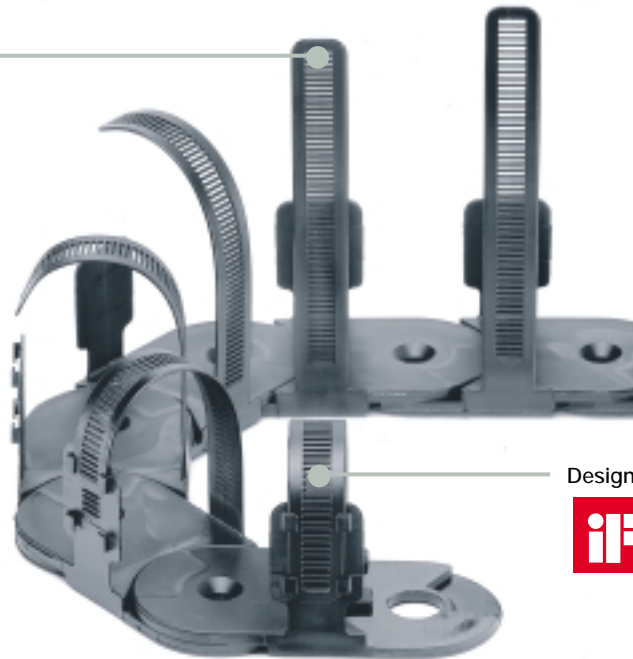

Design Award Winner



## Features

- Cable carriers to easily bundle cables together
- Adjustable loops, can be changed at any time
- Suitable for short lengths, ideally 5 to 10 sections
- Favorable alternative for expensive cable clips
- Version TE can be opened from the outside radius
- Version TZ can be opened from the inside radius
- Elegant Design
- Flexible in one or two directions
- Available in two sizes

## Applications

- Control box construction
- Electrical appliances
- Computer cabinets
- Office furniture
- Any place where cables are moving back and forth

# Series 26 E2 "medium" SnapChain



Snap Chain

## SnapChain - TE26 / TZ26

\*As an alternative available as RBR (reversed bend radius).  
Part No. TE26-120-Radius/Radius

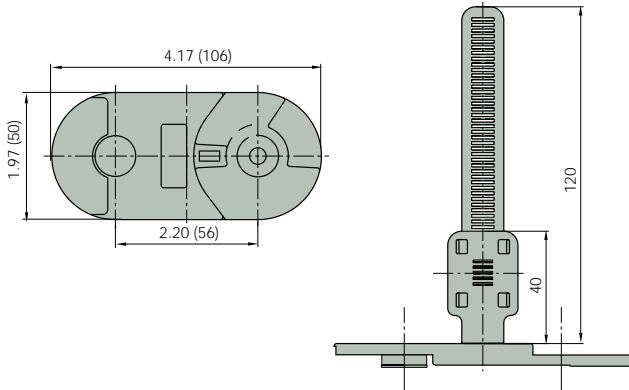

| Part No.  | Bending Radii for ALL Widths |
|-----------|------------------------------|
| TE26-120* | 2.48 (063)                   |
| TZ26-120  | 2.95 (075)                   |
|           | 3.94 (100)                   |
|           | 4.92 (125)                   |
|           | 5.91 (150)                   |
|           | 7.87 (200)                   |

Supplement part no. with required radius for example, TE26-120-100-0

## SnapChain - TE14 / TZ14

\*As an alternative available as RBR (reversed bend radius).  
Part No. TE14-50-Radius/Radius

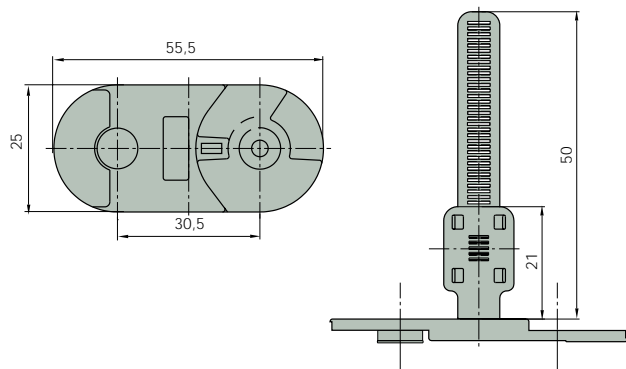

| Part No. | Bending Radii for ALL Widths |
|----------|------------------------------|
| TE14-50* | 1.10 (028)                   |
| TZ14-50  | 1.50 (038)                   |
|          | 1.89 (048)                   |
|          | 2.95 (075)                   |
|          | 3.94 (100)                   |
|          | 4.92 (125)                   |

Supplement part no. with required radius for example, TE14-50-100-0

Serie s  
SnapChain

Telephone 1-800-521-2747  
Fax 1-401-438-7270

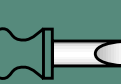

## Interior Separation

### Option 1: vertical separators

Separators are the only option for compartmentalizing the interior of the Series 26 chain. If a large distance between separators is required, it is possible to use separators with wide feet (not Series 26) or spacers. Both are predominantly used for side-mounted Energy Chains®.

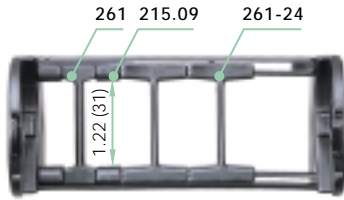

|               |                 |
|---------------|-----------------|
| <b>Spacer</b> |                 |
| Unassembled   | Part No. 205-09 |
| Assembled     | Part No. 215-09 |

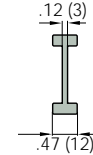

|                           |              |
|---------------------------|--------------|
| <b>Vertical Separator</b> |              |
| Unassembled               | Part No. 260 |
| Assembled                 | Part No. 261 |

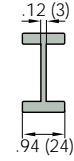

|                           |                 |
|---------------------------|-----------------|
| <b>Vertical Separator</b> |                 |
| Unassembled               | Part No. 260-24 |
| Assembled                 | Part No. 261-24 |

### Option 2: full-width shelf

This option is available for the Series 27/27i snap-open chains. It is used most often with applications involving many thin cables with similar or identical diameters. This variation always fills the entire inner width of the chain.

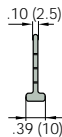
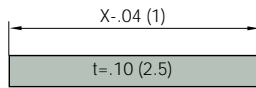
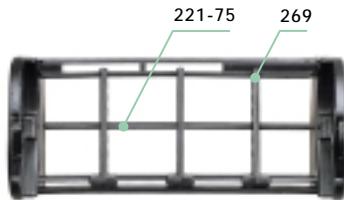

|                                    |              |
|------------------------------------|--------------|
| <b>Vertical Separator, Slotted</b> |              |
| Unassembled                        | Part No. 268 |
| Assembled                          | Part No. 269 |

| Width X<br>in. (mm) | Part No.<br>Unassembled | Part No.<br>Assembled |
|---------------------|-------------------------|-----------------------|
| 1.97 (50)           | 220-50                  | 221-50                |
| 2.95 (75)           | 220-75                  | 221-75                |
| 3.94 (100)          | 220-100                 | 221-100               |
| 4.92 (125)          | 220-125                 | 221-125               |
| 5.91 (150)          | 220-150                 | 221-150               |
| 6.89 (175)          | 220-175                 | 221-175               |
| 7.87 (200)          | 220-200                 | 221-200               |

### Option 3: shelves

This option is available for the Series 27/27i snap-open chains. It is ideal for applications involving many cables with different diameters. It is not possible to achieve continuous interior separation across the entire width of these chains. However, variable compartment heights and widths across the chain width are possible, with the maximum interior separation span equaling the BI value of .79 (20).

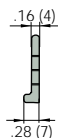
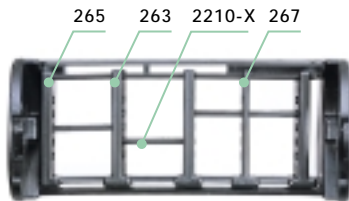

|                   |              |
|-------------------|--------------|
| <b>Side Plate</b> |              |
| Unassembled       | Part No. 264 |
| Assembled         | Part No. 265 |

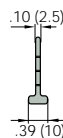

|                                    |              |
|------------------------------------|--------------|
| <b>Vertical Separator, Slotted</b> |              |
| Unassembled                        | Part No. 266 |
| Assembled                          | Part No. 267 |

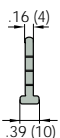

|                                    |              |
|------------------------------------|--------------|
| <b>Vertical Separator, Slotted</b> |              |
| Unassembled                        | Part No. 262 |
| Assembled                          | Part No. 263 |

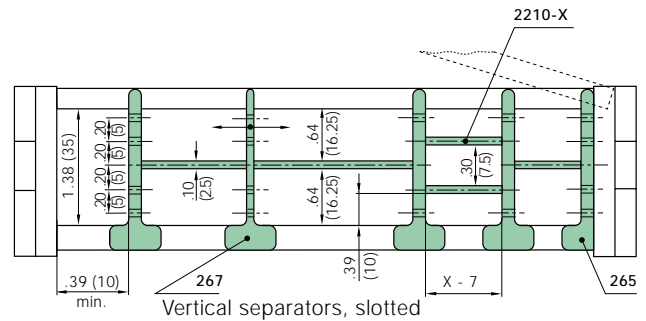

| Width X<br>in. (mm) | Part No.<br>Unassembled | Part No.<br>Assembled |
|---------------------|-------------------------|-----------------------|
| .71 (18)            | 2200-18                 | 2210-18               |
| .91 (23)            | 2200-23                 | 2210-23               |
| 1.10 (28)           | 2200-28                 | 2210-28               |
| 1.30 (33)           | 2200-33                 | 2210-33               |
| 1.50 (38)           | 2200-38                 | 2210-38               |
| 1.69 (43)           | 2200-43                 | 2210-43               |
| 1.89 (48)           | 2200-48                 | 2210-48               |
| 2.28 (58)           | 2200-58                 | 2210-58               |
| 2.68 (68)           | 2200-68                 | 2210-68               |
| 2.87 (73)           | 2200-73                 | 2210-73               |
| 3.46 (88)           | 2200-88                 | 2210-88               |
| 3.90 (99)           | 2200-99                 | 2210-99               |
| 4.88 (124)          | 2200-124                | 2210-124              |

# Series 26/27/27i E2 "medium"



26  
27  
27i

## Mounting Brackets

### Option 1: pivoting

- Pivoting
- Short and long travels
- Space-restricted conditions
- Corrosion-resistant

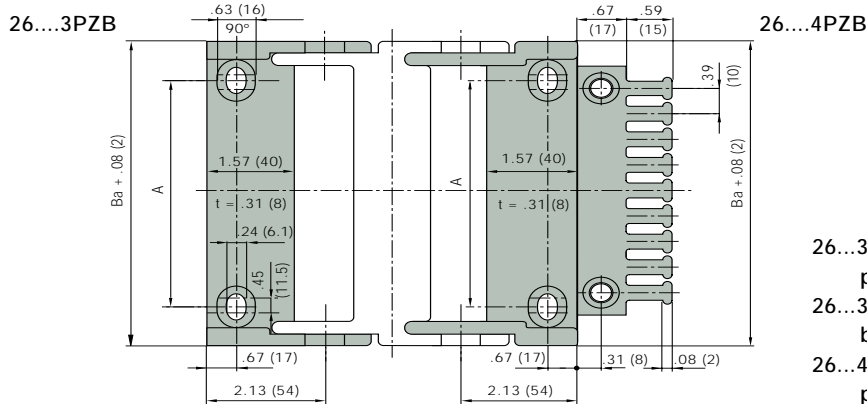
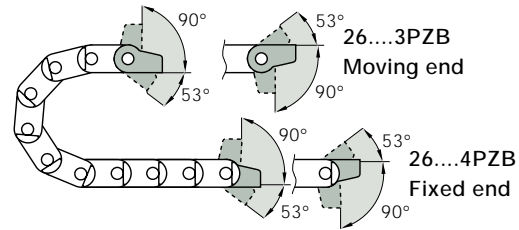

- 26...34 PZB = Full set, each part with pin/bore, including tiewrap plates
- 26...3 PZB = Mounting bracket with bore, including tiewrap plates
- 26...4 PZB = Mounting bracket with pin, including tiewrap plates

| Chain Type   | Part No. Full Set with Tiewrap Plates | Part No. Set with Tiewrap Plates and 10 Cable Tiewraps | Part No. Mounting Bracket Set | Dimension A in. (mm) |
|--------------|---------------------------------------|--|-------------------------------|----------------------|
| 26/27/27i-05 | 2605-34PZB                            | 2605-34PZBK1   | 2605-34PZ                     | 1.18 (30)            |
| 26/27/27i-07 | 2607-34PZB                            | 2607-34PZBK1   | 2607-34PZ                     | 2.17 (55)            |
| 26/27/27i-10 | 2610-34PZB                            | 2610-34PZBK1   | 2610-34PZ                     | 3.15 (80)            |
| 26/27/27i-12 | 2612-34PZB                            | 2612-34PZBK1   | 2612-34PZ                     | 4.13 (105)           |
| 26/27/27i-15 | 2615-34PZB                            | 2615-34PZBK1   | 2615-34PZ                     | 5.12 (130)           |
| 26/27/27i-17 | 2617-34PZB                            | 2617-34PZBK1   | 2617-34PZ                     | 6.10 (155)           |
| 26/27/27i-20 | 2620-34PZB                            | 2620-34PZBK1   | 2620-34PZ                     | 7.09 (180)           |

### Option 2: locking

- Locked connections
- Vertical hanging/standing travels
- Extreme accelerations
- Corrosion-resistant

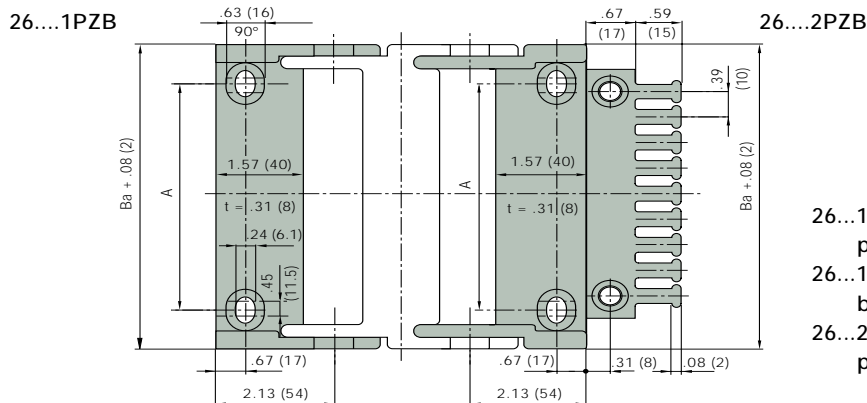
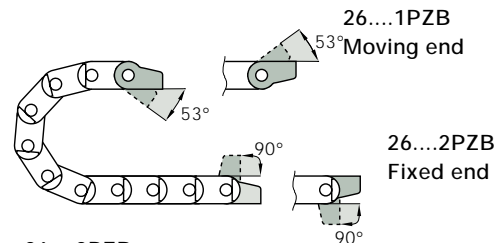

- 26...12 PZB = Full set, each part with pin/bore, including tiewrap plates
- 26...1 PZB = Mounting bracket with bore, including tiewrap plates
- 26...2 PZB = Mounting bracket with pin, including tiewrap plates

| Chain Type   | Part No. Full Set with Tiewrap Plates | Part No. Set with Tiewrap Plates and 10 Cable Tiewraps | Part No. Mounting Bracket Set | Dimension A in. (mm) |
|--------------|---------------------------------------|--|-------------------------------|----------------------|
| 26/27/27i-05 | 2605-12PZB                            | 2605-12PZBK1   | 2605-12PZ                     | 1.18 (30)            |
| 26/27/27i-07 | 2607-12PZB                            | 2607-12PZBK1   | 2607-12PZ                     | 2.17 (55)            |
| 26/27/27i-10 | 2610-12PZB                            | 2610-12PZBK1   | 2610-12PZ                     | 3.15 (80)            |
| 26/27/27i-12 | 2612-12PZB                            | 2612-12PZBK1   | 2612-12PZ                     | 4.13 (105)           |
| 26/27/27i-15 | 2615-12PZB                            | 2615-12PZBK1   | 2615-12PZ                     | 5.12 (130)           |
| 26/27/27i-17 | 2617-12PZB                            | 2617-12PZBK1   | 2617-12PZ                     | 6.10 (155)           |
| 26/27/27i-20 | 2620-12PZB                            | 2620-12PZBK1   | 2620-12PZ                     | 7.09 (180)           |

Series  
26/27/27i

Telephone 1-800-521-2747  
Fax 1-401-438-7270



### Mounting Brackets

#### Option 3: KMA pivoting

- Pivoting
- Short and long travels
- Optional integrated profile rail for strain relief
- Bolted connection outside of chain cross section
- Space-restricted conditions
- Corrosion-resistant
- Universal use

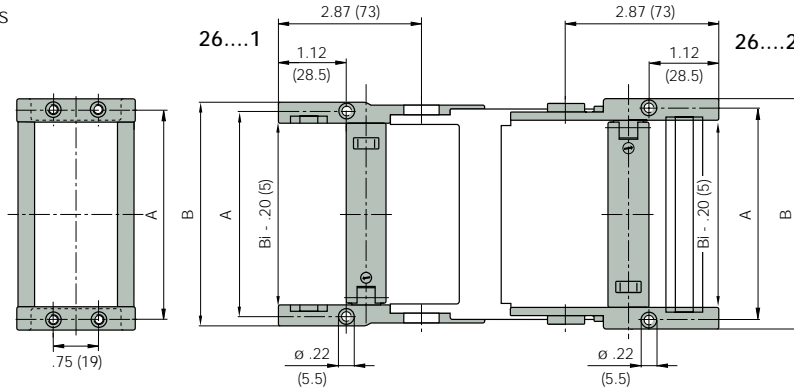
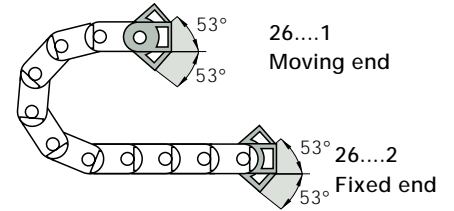

| Chain Type   | Part No. Full Set with Profile Rail | Part No. Set Mounting Brackets | Dimension A in. (mm) | Dimension B in. (mm) |
|--------------|-------------------------------------|--------------------------------|----------------------|----------------------|
| 26/27/27i-05 | 2600-05-12P                         | 2600-05-12                     | 2.28 (58)            | 2.72 (69)            |
| 26/27/27i-07 | 2600-07-12P                         | 2600-07-12                     | 3.27 (83)            | 3.70 (94)            |
| 26/27/27i-10 | 2600-10-12P                         | 2600-10-12                     | 4.25 (108)           | 4.69 (119)           |
| 26/27/27i-12 | 2600-12-12P                         | 2600-12-12                     | 5.24 (133)           | 5.67 (144)           |
| 26/27/27i-15 | 2600-15-12P                         | 2600-15-12                     | 6.22 (158)           | 6.65 (169)           |
| 26/27/27i-17 | 2600-17-12P                         | 2600-17-12                     | 7.20 (183)           | 7.64 (194)           |
| 26/27/27i-20 | 2600-20-12P                         | 2600-20-12                     | 8.19 (208)           | 8.62 (219)           |

26...12 = Full set, each part with pin/bore  
26...1 = Mounting bracket with bore  
26...2 = Mounting bracket with pin

#### Option 4: KMA locking

- Locked connections
- Vertical hanging/standing travels
- Optional integrated profile rail for strain relief
- Bolted connection outside of chain cross section
- Extreme accelerations
- Corrosion-resistant
- Universal use

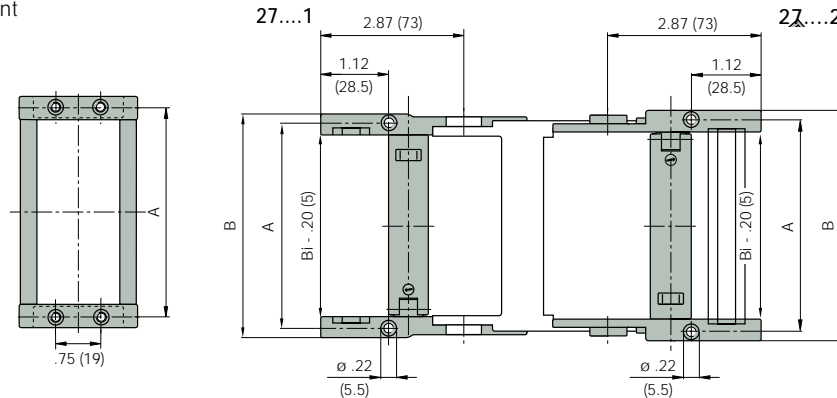
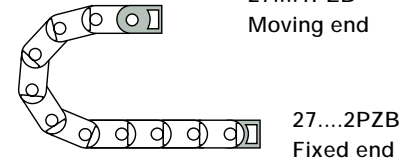

| Chain Type   | Part No. Full Set with Profile Rail | Part No. Set Mounting Brackets | Dimension A in. (mm) | Dimension B in. (mm) |
|--------------|-------------------------------------|--------------------------------|----------------------|----------------------|
| 26/27/27i-05 | 2700-05-12P                         | 2700-05-12                     | 2.28 (58)            | 2.72 (69)            |
| 26/27/27i-07 | 2700-07-12P                         | 2700-07-12                     | 3.27 (83)            | 3.70 (94)            |
| 26/27/27i-10 | 2700-10-12P                         | 2700-10-12                     | 4.25 (108)           | 4.69 (119)           |
| 26/27/27i-12 | 2700-12-12P                         | 2700-12-12                     | 5.24 (133)           | 5.67 (144)           |
| 26/27/27i-15 | 2700-15-12P                         | 2700-15-12                     | 6.22 (158)           | 6.65 (169)           |
| 26/27/27i-17 | 2700-17-12P                         | 2700-17-12                     | 7.20 (183)           | 7.64 (194)           |
| 26/27/27i-20 | 2700-20-12P                         | 2700-20-12                     | 8.19 (208)           | 8.62 (219)           |

26...12 = Full set, each part with pin/bore  
26...1 = Mounting bracket with bore  
26...2 = Mounting bracket with pin

# Series 26/27/27i E2 "medium"



26  
27  
27i

## Mounting Brackets

### Option 5: Steel

- One part for all chain widths
- Electrically conductive
- Bolted connection outside of chain cross section

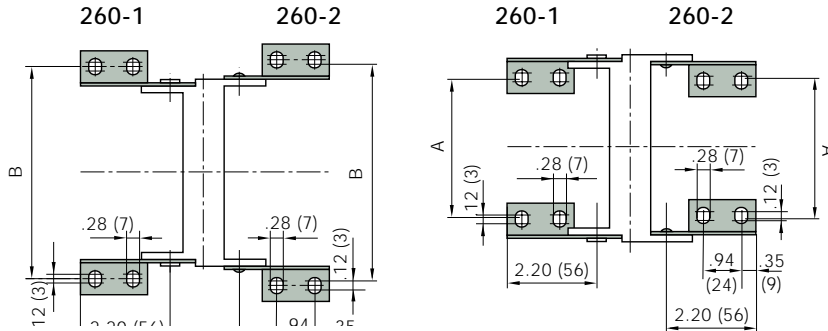
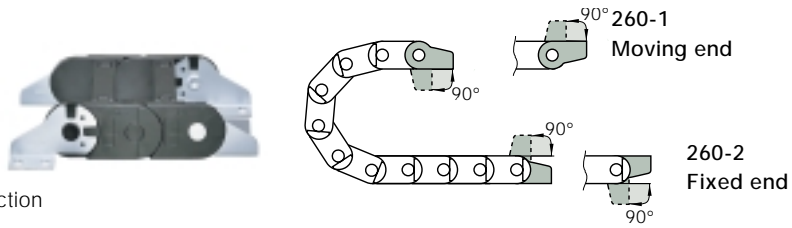

| Chain Type   | Part No.<br>Full Set | Dimension A |        | Dimension B |       |
|--------------|----------------------|-------------|--------|-------------|-------|
|              |                      | in.         | (mm)   | in.         | (mm)  |
| 26/27/27i-05 | 260-12               | 1.44        | (36.5) | 3.31        | (84)  |
| 26/27/27i-07 | 260-12               | 2.44        | (62)   | 4.25        | (108) |
| 26/27/27i-10 | 260-12               | 3.43        | (87)   | 5.24        | (133) |
| 26/27/27i-12 | 260-12               | 4.41        | (112)  | 6.22        | (158) |
| 26/27/27i-15 | 260-12               | 5.39        | (137)  | 7.20        | (183) |
| 26/27/27i-17 | 260-12               | 6.42        | (163)  | 8.23        | (209) |
| 26/27/27i-20 | 260-12               | 7.40        | (188)  | 9.21        | (234) |

260-12 = Full set, every second part with pin/bore  
 260-1 = Mounting bracket with bore, 1 part left/right  
 260-2 = Mounting bracket with pin, 1 part left/right

Series  
26/27/27i

Telephone 1-800-521-2747  
 Fax 1-401-438-7270

## Strain Relief for Polymer Mounting Brackets (pivoting or locking)

The strain relief tiwrap plates can be snapped directly onto the mounting bracket without additional hardware. When the mounting brackets are bolted into place, the tiwrap plates are also connected firmly to the machine surface. No separate installation is necessary. Cable tiwraps secure cables using the "teeth" of the tiwrap plate for time-saving, effective strain relief.



### Tiwrap plate as an individual part

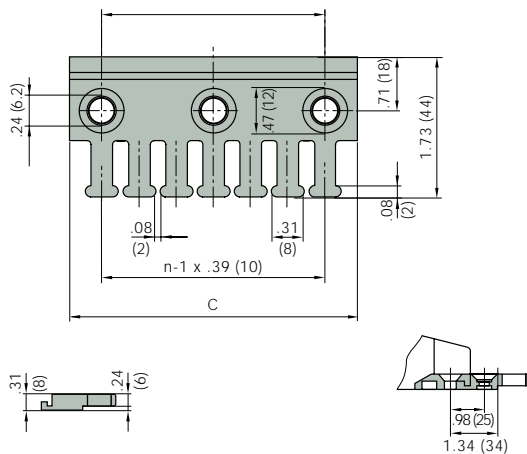

Single tiwrap plate

Shown assembled

| Tiwrap Plates | n<br>Number of Teeth | C<br>Overall Width | B<br>Distance Between Bore Holes | Center Bore Holes |
|---------------|----------------------|--------------------|----------------------------------|-------------------|
| 3050-ZB       | 5                    | 1.97 (50)          | 1.18 (30)                        | no                |
| 3075-ZB       | 7                    | 2.95 (75)          | 2.17 (55)                        | no                |
| 3100-ZB       | 10                   | 3.94 (100)         | 3.15 (80)                        | no                |
| 3125-ZB       | 12                   | 4.92 (125)         | 4.13 (105)                       | no                |
| 3150-ZB       | 15                   | 5.91 (150)         | 5.12 (130)                       | no                |
| 3175-ZB       | 17                   | 6.89 (175)         | 6.10 (155)                       | no                |
| 3200-ZB       | 20                   | 7.87 (200)         | 7.09 (180)                       | yes               |

### Cable tiwraps as individual parts

| Cable tiwraps<br>100 pieces/bag | Width x Length |             | Maximum Ø |      | Tensile Strength |       |
|---------------------------------|----------------|-------------|-----------|------|------------------|-------|
|                                 | in.            | (mm)        | in.       | (mm) | lbs              | (N)   |
| CFB-001                         | .19 x 5.91     | (4.8 x 150) | 1.42      | (36) | 50               | (222) |

- Other strain relief elements
- ▶ Strain Relief, Chapter 10



### "Double" strain relief

If an Energy Chain® is harnessed with a very large number of cables, strain relief may be necessary at two levels. Our 2050-Z strain relief system was developed for this purpose. It can be placed in any position along the Energy Chain®. The 2050-Z strain relief system is simply clamped onto the opening crossbar or onto the fixed crossbar of the chain link, as needed. No additional installation elements are needed. Attachment directly onto the KMA crossbars is possible.



| Part No. | Width, Strain Relief<br>in. (mm) |
|----------|----------------------------------|
| 2050-ZC  | 1.97 (50)                        |

\* Additional widths under preparation

### Strain relief for KMA

When a profile rail is used, the strain relief element can be attached directly to the KMA brackets without using any bolts. This is accomplished by simply clamping the tiewrap plate onto the profile rail. The profile rail can be placed at the top, bottom or both top and bottom of the KMA bracket to accommodate both tiewrap plates and strain relief clamps simultaneously.



### Clip-on tiewrap plates for the profile rail

For easy assembly without bolts, the 3050-ZC and 3075-ZC plates can be clipped directly into the profile rail without a bolt assembly.



| Part No. for Fixed Port | Part No. for Crossbars or KMA | Width, Strain Relief<br>in. (mm) |
|-------------------------|-------------------------------|----------------------------------|
| 3050-Z                  | 3050-ZS                       | 1.97 (50)                        |
| 3075-Z                  | 3075-ZS                       | 2.95 (75)                        |

### Strain relief for KMA and steel mounting brackets

Clip-on connection is not possible with steel mounting brackets. In this case, the tiewrap plates must be bolted directly into separate bore holes in front of the mounting bracket.

► Chapter 10



# Order Example and Technical Data: Series 26/27/27i E2 "medium"



26  
27  
27i

## Order example

27-10...

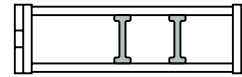
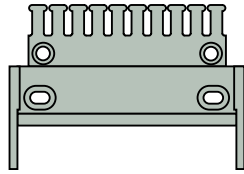
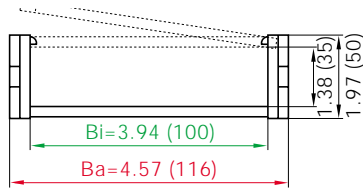

### 1. Chain selection:

27-10-100-0

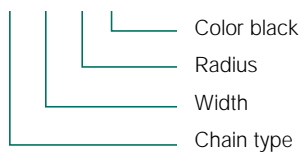

### 2. Mounting brackets:

2610-34-PZB

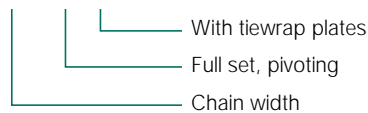

### 3. Interior separation:

2 separators unassembled (Part No. 260), or assembled every other link (Part No. 261).

Alternative interior separation configuration according to design layout possible.

For 16.4 ft (5 m) chain, color black, with pivoting mounting brackets  
16.4 ft (5 m) 27-10-100-0 and 2610-34PZ

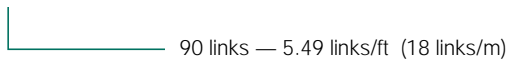

4. Additional information on guide troughs ► Page 4.58

## Technical data

| Chain Type   | Weight Per Link |         | Weight   |        |
|--------------|-----------------|---------|----------|--------|
|              | (oz.)           | (g)     | (lbs/ft) | (kg/m) |
| 26/27/27i-05 | 0.143           | (0.065) | 0.79     | (1.17) |
| 26/27/27i-07 | 0.159           | (0.072) | 0.87     | (1.30) |
| 26/27/27i-10 | 0.170           | (0.077) | 0.93     | (1.39) |
| 26/27/27i-12 | 0.181           | (0.082) | 0.99     | (1.48) |
| 26/27/27i-15 | 0.198           | (0.090) | 1.09     | (1.62) |
| 26/27/27i-17 | 0.227           | (0.103) | 1.24     | (1.85) |
| 26/27/27i-20 | 0.240           | (0.109) | 1.32     | (1.96) |

|                       |                           |
|-----------------------|---------------------------|
| Material              | igumid G                  |
| Permitted temperature | -40°/+266°F (-40°/+130°C) |
| Gliding speed max.    | 16.4 ft/s (5 m/s)         |
| Unsupported V max.    | 32.8 ft/s (10 m/s)        |
| Flammability class    | VDE 0304 IIC UL94 HB      |

● Details of material properties

► Design, Chapter 1

### Guide Troughs



● Other technical data on guide troughs

► Chapter 9

Series  
26/27/27i

Telephone 1-800-521-2747  
Fax 1-401-438-7270

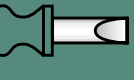

### Assembly Instructions

igus® Energy Chain Systems®

Telephone 1-800-521-2747  
Fax 1-401-438-7270

igus®, inc.  
USA/Canada  
Mexico

Internet: <http://www.igus.com>  
email: [webmaster@igus.com](mailto:webmaster@igus.com)



1. To open crossbars: press screwdriver into tab on top of link, lever screwdriver until crossbar opens



2. Repeat Step 1 on other side



3. To close crossbars: push down on crossbar with thumb until it snaps into place



4. Joining chain sections: push sections together; angle one side until pin snaps into bore; repeat on other side



5. Separating chain sections: insert screwdriver between two links



6. Twist until pin disengages from bore; pull sections apart



7. Attaching mounting brackets: snap bracket into link (see Step 4 - "Joining chain sections")



8. Snap tie-wrap plate into bottom groove of the mounting bracket

### Guide Troughs

Guide troughs are used with applications where the upper run of the Energy Chain® glides on the lower run. If using igus® steel guide troughs, the following components are required:

- Full travel length of guide trough  
Part Number 95-30
- 1/2 travel length of glide bars  
Part number 92-01
- Installation sets as end connectors  
Part Number 95-50-XX

-XX indicates the length of the profile rail on which the guide trough is mounted. The values and part numbers are specified in the table on the left. The standard length of the trough components and glide bars is 6.56 ft (2 m.) The required overall length of the guide trough directly correlates to the length of travel.

#### Example:

Length of travel 164 ft (50 m)  
Center mounted

**Required guide troughs:**  
164 ft (50 m) guide trough  
82 ft (25 m) glide bar

= 25 sections of 6.56 ft (2 m) guide trough

Part No. 95-30

= 13 sections of 6.56 ft (2 m) glide bar

Part No. 92-01

**Required number of installation sets:**

= Number of guide trough components + 1

= 25 + 1 = 26

Part number of the installation sets

Example: 95-50-400 for 15.75" (400 mm) long profile rail.



| Width of Crossbar<br>27-05-200-0 | Dimension D | Installation Part No. |
|----------------------------------|-------------|-----------------------|
| -05 2.80 (71)                    |             | 95-50-200             |
| -07 3.78 (96)                    |             | 95-50-200             |
| -10 4.76 (121)                   |             | 95-50-250             |
| -12 5.75 (146)                   |             | 95-50-250             |
| -15 6.73 (171)                   |             | 95-50-300             |
| -17 7.83 (199)                   |             | 95-50-300             |
| -20 8.82 (224)                   |             | 95-50-350             |

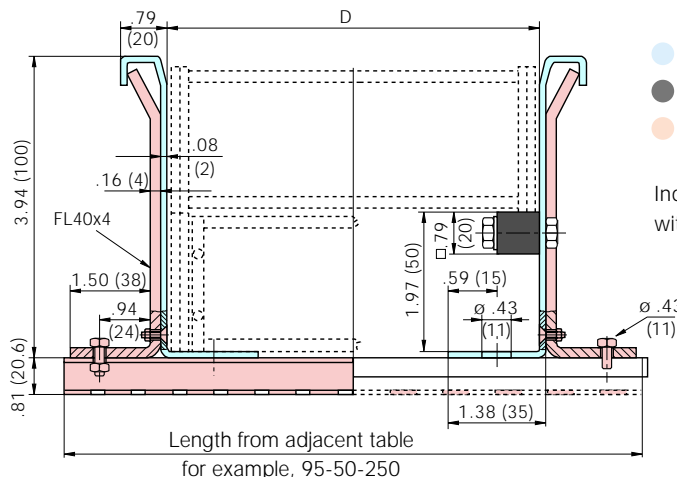

- Guide trough
- Glide bars
- Installation set

Individual attachment without profile rail

\* Specialized guide trough available upon request



igus® Energy Chain  
System®

Telephone 1-800-521-2747  
Fax 1-401-438-7270

igus®, inc.  
USA/Canada

Internet: <http://www.igus.com>  
email: [webmaster@igus.com](mailto:webmaster@igus.com)